

Držači DIN6359 za alate sa cilindričnom drškom
DIN 1835B (Weldon) «FORM-LINE»

SAB

DIN 69871

Zwischenhülsen für Zylinderschäfte «FORM-LINE»
Adaptor sleeves for parallel shanks «FORM-LINE»
Mandrin pour outils a queue cylindrique a meplat «FORM-LINE»

Isporuka : sa ugrađenim vijcima za stezanje
Lieferumfang : mit eingebauter Spannschraube
Delivery : adaptor with built in locking screw
Livraison : avec vis de serrage

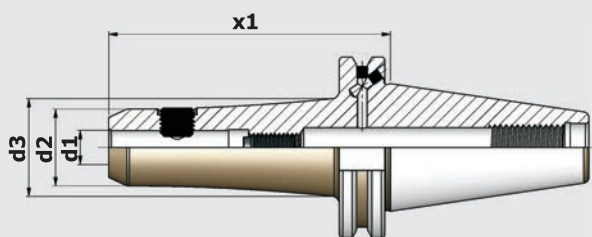

Konus	d1	x1	d2	d3	code
Kegel Taper Cone	6	100	17	25	WE06.D44.100F
	6	130	17	30	WE06.D44.130F
40	6	160	17	31	WE06.D44.160F
69871 AD+B	8	100	21	29	WE08.D44.100F
	8	130	21	35	WE08.D44.130F
	8	160	21	35	WE08.D44.160F
$\sqrt{\text{R}} \leq 3\mu$	10	100	24	32	WE10.D44.100F
	10	130	24	37	WE10.D44.130F
	10	160	24	38	WE10.D44.160F
G2.5 25.000	12	100	27	35	WE12.D44.100F
	12	130	27	40	WE12.D44.130F
	12	160	27	41	WE12.D44.160F
Fe-Ni	14	100	29	37	WE14.D44.100F
	14	130	29	42	WE14.D44.130F
	14	160	29	43	WE14.D44.160F
	16	100	33	41	WE16.D44.100F
	16	130	33	46	WE16.D44.130F
	16	160	33	47	WE16.D44.160F
	18	100	35	43	WE18.D44.100F
	18	130	35	48	WE18.D44.130F
	18	160	35	49	WE18.D44.160F
	20	100	39	47	WE20.D44.100F
	20	130	39	50	WE20.D44.130F
	20	160	39	50	WE20.D44.160F
	25	100	47	47	WE25.D44.100F
	25	130	47	47	WE25.D44.130F
	25	160	47	47	WE25.D44.160F
	32	100	57	57	WE32.D44.100F
	32	130	57	57	WE32.D44.130F
	32	160	57	57	WE32.D44.160F

Konus	d1	x1	d2	d3	code
Kegel Taper Cone	6	100	17	25	WE06.D55.100F
	6	130	17	30	WE06.D55.130F
50	6	160	17	31	WE06.D55.160F
	6	200	17	40	WE06.D55.200F
69871 AD+B	8	100	21	29	WE08.D55.100F
	8	130	21	34	WE08.D55.130F
	8	160	21	35	WE08.D55.160F
	8	200	21	44	WE08.D55.200F
$\sqrt{\text{R}} \leq 3\mu$	10	100	24	32	WE10.D55.100F
	10	130	24	37	WE10.D55.130F
	10	160	24	38	WE10.D55.160F
	10	200	24	47	WE10.D55.200F
G6.3 25.000	12	100	27	35	WE12.D55.100F
	12	130	27	40	WE12.D55.130F
	12	160	27	41	WE12.D55.160F
	12	200	27	50	WE12.D55.200F
Fe-Ni	14	100	29	37	WE14.D55.100F
	14	130	29	42	WE14.D55.130F
	14	160	29	43	WE14.D55.160F
	14	200	29	52	WE14.D55.200F
	16	100	33	41	WE16.D55.100F
	16	130	33	46	WE16.D55.130F
	16	160	33	47	WE16.D55.160F
	16	200	33	56	WE16.D55.200F
	18	100	35	43	WE18.D55.100F
	18	130	35	48	WE18.D55.130F
	18	160	35	49	WE18.D55.160F
	18	200	35	58	WE18.D55.200F
	20	100	39	47	WE20.D55.100F
	20	130	39	52	WE20.D55.130F
	20	160	39	53	WE20.D55.160F
	20	200	39	62	WE20.D55.200F
	25	100	47	55	WE25.D55.100F
	25	130	47	60	WE25.D55.130F
	25	160	47	61	WE25.D55.160F
	25	200	47	70	WE25.D55.200F
	32	130	57	70	WE32.D55.130F
	32	160	57	71	WE32.D55.160F
	32	200	57	72	WE32.D55.200F

Rezervni dijelovi/ Ersatzteile/ Spare parts/ Accessoires

WE	Mxl	code
6	M6x6	WE.06.F
8	M8x7,5	WE.08.F
10	M10x8	WE.10.F
12	M12x8	WE.12.F
14	M12x8,5	WE.14.F
16	M14x8,5	WE.16.F
18	M14x8,5	WE.18.F
20	M16x10	WE.20.F
25	M18x2x11,5	WE.25.F
32	M20x2x13	WE.32.F

